



Ashwin Court, Bretforton, WR11 7HL

**SHELDON
BOSLEY
KNIGHT**

LAND AND
PROPERTY
PROFESSIONALS

Property Description

This charming one-bedroom Grade II Listed freehold cottage is full of character and set within the historic village of Bretforton. Nestled in a picturesque setting with beautifully maintained communal gardens, the property is offered to the market with no onward chain.

The accommodation features an inviting open-plan kitchen and living area, complete with a cosy gas stove, and a striking spiral staircase leading to the first floor. Upstairs, you'll find a spacious double bedroom and a well-appointed bathroom.

Additional benefits include allocated parking, visitor parking, and access to the attractive communal gardens.



Key Features

- NO ONWARD CHAIN
- ONE BEDROOM GRADE II LISTED COTTAGE
- OPEN-PLAN RECEPTION ROOM
- FITTED KITCHEN
- CHARACTER FEATURES
- DOUBLE BEDROOM
- MODERN BATHROOM
- COMMUNAL PARKING & GARDENS
- EPC RATING = D

**Offers Over
£200,000**





Ground Floor

Approx. 30.7 sq. metres (330.7 sq. feet)

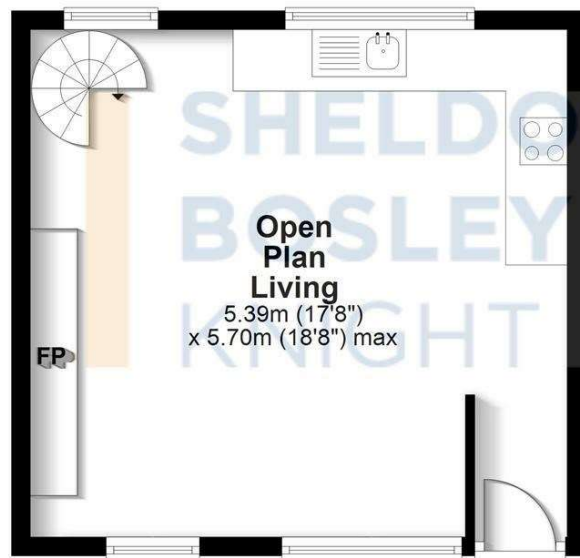

First Floor

Approx. 30.8 sq. metres (331.7 sq. feet)

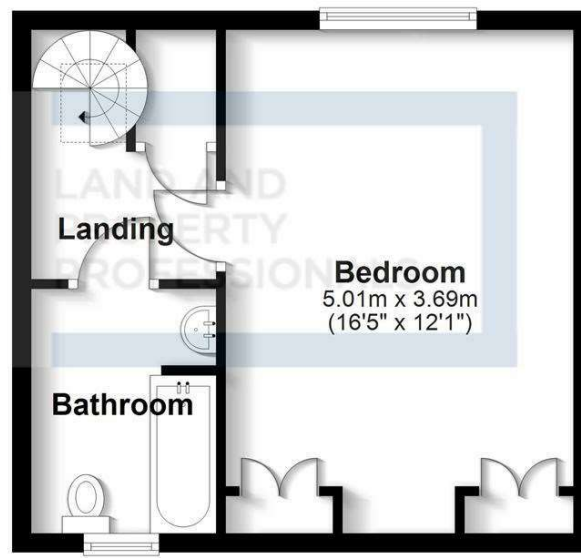

Total area: approx. 61.5 sq. metres (662.4 sq. feet)

All efforts have been made to ensure the measurements are accurate, however these are for guidance purposes only.
Plan produced using PlanUp.



EPC Rating - D

Tenure - Freehold

Council Tax Band - C

Local Authority
Wychavon District Council



We routinely refer clients to both our recommended legal firm and a panel of financial services providers. It is your decision whether you choose to deal with these companies. In making that decision, you should know that we receive a referral fee.

**SHELDON
BOSLEY
KNIGHT**

LAND AND
PROPERTY
PROFESSIONALS